



Spray guns ESTA

Manual electrostatic spray guns



Product families

EcoGun MAN ESTA – manual electrostatic spray guns



EcoGun MAN ESTA

Manual electrostatic spray guns

The line of manual electrostatic spray guns involves models with external or direct charge for air spray application method. These spray guns are the perfect solution to reduce overspray when deploying manual paint application. They are suitable for solvent or water-borne paints. Small size and light weight are providing long lasting operation without significant fatigue.



PRODUCT LINE		
	EcoGun AS MAN EC	EcoGun AS MAN DC
Part No.	see page 37	see page 37
Connector fluid	G3/8" with 60° inner cone (male)	G3/8" with 60° inner cone (male)
Max. fluid pressure	6.0 bar (87 psi)	6.0 bar (87 psi)
Connector air	G1/4" with 60° inner cone (male)	G1/4" with 60° inner cone (male)
Max. operating voltage	30 kV	60 kV
Nozzle sizes	1.1 mm	1.1 mm
Technical highlights	External charging needle. Built-in control lamp to indicate high voltage. High voltage only if the trigger is pulled.	Internal charge via electrode on tip of the needle. Built-in control lamp to indicate high voltage. High voltage only if the trigger is pulled. Model for clear and base coats. Model for metallic coats.
Field of use	For water-borne clear and base coats and fillers.	For solvent-borne clear, metallic and base coats and fillers. A model with insulated material hose is available for water-borne paints.

CUSTOMER BENEFITS



Solvent resistant composite body guarantees a light weight and a long life

Maximum charge of 60 kV for high transfer efficiency

Direct and external charging system available

Fine atomization even without high voltage Suitable for solvent-borne paints

TECHNICAL ILLUSTRATION

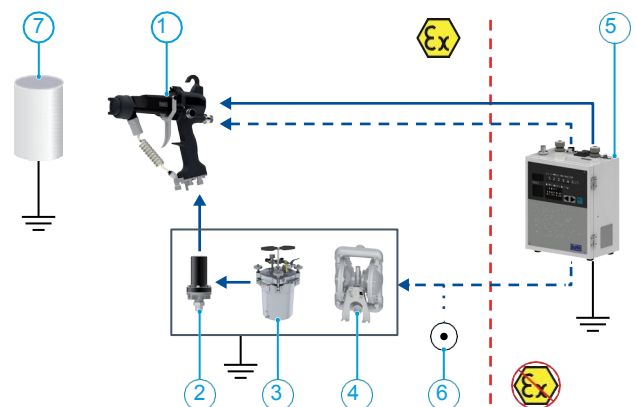

1 EcoGun AS MAN DC, 2 EcoFlow LPF, 3 Pressure pot 10, 4 EcoPump AD, 5 Controller EcoHT 80, 6 Air supply, 7 Coated part

EcoGun MAN ESTA

Manual electrostatic spray guns



AIR CAPS			
	Air cap HN400	Air cap HN600	Air cap HN800
Part No.	M35030249	M35030250	M35030251
Compatible spray guns	EcoGun AS MAN EC, EcoGun AS MAN DC	EcoGun AS MAN EC, EcoGun AS MAN DC	EcoGun AS MAN EC, EcoGun AS MAN DC
Specification	Small spray pattern, recommended material flow rate 50-150 ml/min.	Medium spray pattern, recommended material flow rate 140-280 ml/min.	large spray pattern, recommended material flow rate 240-400 ml/min.
Field of use	less air flutter and flat pattern. Suitable for small or narrow work.	Standard type can realize both high transfer efficiency and appearance.	High atomization model for high viscosity or high flow rate.



SELECTED ACCESSORIES			
	EcoHT 80 Controller	Hoses	Extension cables
Part No.	E80020003 (100-120V) E80020004 (200-240V) E80020006 (200-240V, for guns in ATEX-zone)	see hoses on page no. 119	E09070247 (10 m) E09070248 (20 m)
Compatible spray guns	EcoGun AS MAN EC, EcoGun AS MAN DC	EcoGun AS MAN EC, EcoGun AS MAN DC	EcoGun AS MAN EC, EcoGun AS MAN DC

Complete list of accessories can be found in the webshop.

ORDER NUMBERS – EcoGun AS MAN DC & EcoGun AS MAN EC

Part no.	Scope of delivery	Charge	Paint type	Certification
N36180001V	Depending on configuration	External charge	Water-based paints	Class I Div 1 Group D
N36190001V	Depending on configuration	Direct charge	Depending on configuration	Class I Div 1 Group D
N36180001 *	Spray gun	External charge	Water-based paints	Ex II 2G 0.24mJ
N36190001 *	Spray gun	Direct charge	Metallic paints	Ex II 2G 0.24mJ
N36190003 *	Spray gun	Direct charge	Water-based paints	Ex II 2G 0.24mJ
N36190005 *	Spray gun	Direct charge	Solvent-based paints	Ex II 2G 0.24mJ
N36180002 *	Package (spray gun, hoses and cable - 10m, controller)	External charge	Water-based paints	Ex II 2G 0.24mJ
N36190002 *	Package (spray gun, hoses and cable - 10m, controller)	Direct charge	Metallic paints	Ex II 2G 0.24mJ
N36190004 *	Package (spray gun, hoses and cable - 10m, controller)	Direct charge	Water-based paints	Ex II 2G 0.24mJ
N36190006 *	Package (spray gun, hoses and cable - 10m, controller)	Direct charge	Solvent-based paints	Ex II 2G 0.24mJ

* Air cap needs to be ordered separately!