



Dosing units

Solution for 2K and 3K paint application



Product families

EcoDose 2K – dosing units for two component materials

EcoDose 3K – dosing units for three component materials

EcoDose 2K Easy – dosing unit for two component materials

EcoDose 2K

Dosing units for two component materials

The Dürr **EcoDose 2K** unit is an electronic dosing system suitable for high and low pressure applications. It can be used in manual and automatic processes. Optimized for quick color changes and easy flushing, it enhances resource utilization and contributes to higher application efficiency. Fluids are measured consistently and precisely, even media with different viscosities. Typical fluids handled are 1K or 2K materials, water and solvent-borne paints, varnishes, lacquers and monolayer paints.



TECHNICAL ILLUSTRATION

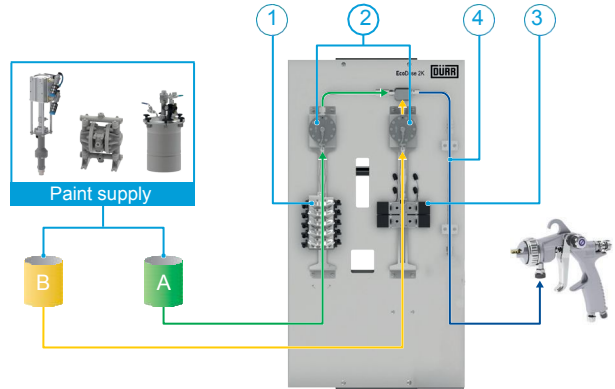

1 Color change block component A, 2 Flow control / Measuring cell component A & B
3 Color change block component B, 4 Static mixer component A & B

TECHNICAL ILLUSTRATION

	EcoDose 2K
Part No.	N10100003V
Max. fluid pressure	20 / 160 / 200 bar (290 / 2,320 / 2,900 psi)
Flow rate	40 – 4.000 cc/min *
Fluid viscosity range	30 – 2.000 mPas (cps) **
Mixing ratio	1:0 / 1:1 – 30:1
Flow meter type	Coriolis / Gear wheel
Temperature measurement	yes (Coriolis only) - upon request

* Depending on flow meter type and fluid technical specs. (viscosity, paint supply equipment and pressures, ...)

** Range to be considered as general indication, actual values depending on job related paintshop conditions

CONNECTION SCHEME

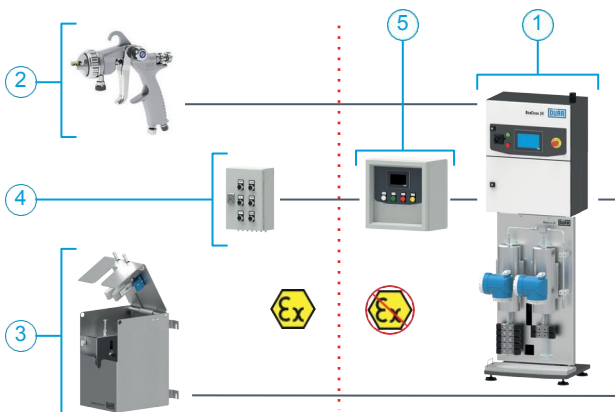

1 EcoDose 2K, 2 EcoGun, 3 Spray gun cleaner, 4 Pneumatic remote control, 5 Remote control HMI

CUSTOMER BENEFITS



- Flow rate measurement by Coriolis or gear flow measuring cell
- Exact volumetric dosing of both components
- Constant and precise accuracy of the mixing ratio
- Monitoring of all dosing functions such as pot life, flow- / mixing ratio of the single and mixed components incl. dedicated alarms
- Automatic color change
- Independent flushing circuits for both components
- No premixing chamber
- Implementation and control of the EcoDose 2K via higher level control possible
- Intuitive user interface for quick programming of individual settings
- High process reliability
- Automatic flow control with programmed setpoint [cc/min] available without additional hardware
- Optional remote diagnosis and remote control available

EcoDose 2K

Dosing units for two component materials

ORDER CODE

EcoDose 2K		Code	Option
Option	Code		
Pressure range *			Version
low pressure (max. 20 bar)	20	EU	EU
High pressure (max. 160 / 200 bar)	200	US	US
Application process			Closed loop flow control
Standard Mode	MG	y	yes
Design		N	No
Mounted on stand	S		Preparation for dump valve
Remote fluid sect., stand	RS	y	yes
Remote fluid sect., no stand	RNS	N	No
Isolation for high tension			Preparation remote diagnosis
No	N	y	yes **
Drip tray		N	No
No	N		Remote control
yes	y	N	None
Filter compressed air inlet		M	Magnetic switch box (Non Ex)
None	N	P	Pneumatic with separate visualisation (Ex)
5 µm	F5		Preparation EcoGun Cleaner M
Signal tower		1GC	1 EcoGun Cleaner M
None	N	2GC	2 EcoGun Cleaner M
Three colors	ST	N	None
Flow control type comp. A ***			No. of controlled atomizers
Gear 0.005..2 l/min	GF1	1A	1
Gear 0.02..3 l/min	GF2	2A	2
Coriolis (160 bar)	CF1		Color flow regulator
Coriolis (200 bar)	CF2	N	None
Flow control type comp. B ***		P25	Pneumatic 2.5 l/min
Gear 0.005..2 l/min	GF1		Mixing ratio
Gear 0.02..3 l/min	GF2	IR	< 10:1
Coriolis (160 bar)	CF1	HR	> 10:1
Coriolis (200 bar)	CF2		No. of component A - deadend (paint)
No. of component B - deadend (catalyst)		1-10	2/4/6/8/10 (20bar) 1/3/5/7/9 (160/200bar) ****
1	1		No. of component A - circulation (paint)
3	3	2-10	2/4/6/8/10 (20bar) ****

* High pressure system available with Coriolis 160 bar or 200 bar

** GSM card not scope of supply

*** Available also with mixed configuration of flow control (coriolis and gear flow meter)

**** Max. 10 colors in combination circulation and deadend (20bar) possible